

DESCRIPTION

The XS-90 smart code reader is a high-performance device designed to effortlessly handle a wide array of 1D and 2D codes. With an impressive maximum reading speed of 30 codes per second, it excels at quickly and accurately decoding various code types. Its outstanding performance is the result of utilising a cutting-edge deep learning algorithm, ensuring consistent and dependable image processing, and enabling the recognition of multiple codes with precision.

FEATURES

- Built-in deep learning model enables accurate code reading
- Utilises LED aiming lights for precise code alignment assistance
- Incorporates a buzzer and indicator to communicate device status effectively
- Supports one-click parameter adjustments for user-friendly operation
- Features multiple IO interfaces along with a plug-in power interface for connectivity enhancement
- Compact design, occupying minimal space

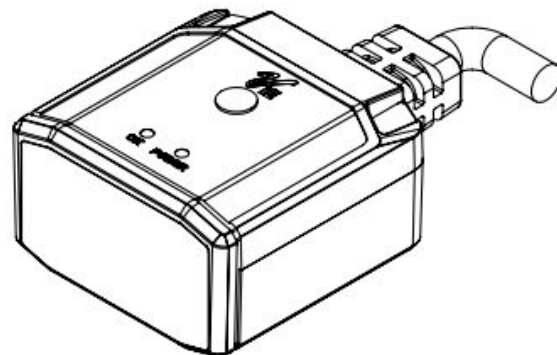

SPECIFICATION

General Specifications

| | |
|-----------------------|---|
| Product ID | 9808-001/ 9808-002/ 9808-003/ 9808-004 |
| Model | XS-90 |
| Model Description | Industrial Code Reader - XS-90 Series 1.3MP |
| Dimension (L x W x H) | 45 mm (L) × 43 mm (W) × 25 mm (H) (1.7716" × 1.6929" × 0.9842") |
| Weight | 70 g ± 10 g (0.1543 lb. ± 0.0220 lb.) |
| Power Consumption | 2.4 W @ 24 VDC |
| Compliance | CE, UL, Mexico NOM |
| Country of Origin | Malaysia |
| Manufacturer | ViE Technologies Sdn. Bhd. |

Technical Specifications

| Type | | XS-90 |
|----------|--------------------------|-----------------------------|
| Receiver | Sensor | CMOS (Mono, Global Shutter) |
| | Resolution | 1280 × 1024 |
| | Lens Mounting | M5.8-mount |
| | Focus | Fixed |
| | Maximum Frame Rate (FPS) | 50 |
| | Focal Length | 4.7 mm (0.1850") |
| | Pixel Size | 2.7 µm × 2.7 µm |
| | Sensor Size | 1/4" |

The product details are subject to change without further notice.

SPECIFICATION

| Type | | | XS-90 |
|------------------------|----------------------------------|------------------------|---|
| Receiver | Exposure Time | | 60 μ s to 6000 μ s |
| | Gain | | 1 dB to 28 dB |
| Emitter | Illumination Light Source Option | | High Intensity Red / White / Red (polarised) / White (polarised) *1 |
| | Pointer Light Source | | Green LED *1 |
| Reading Specification | Supported Symbols | 2D Codes | QR Code and Data Matrix |
| | | Barcodes | Code 39, Code 93, Code 128, CodaBar, EAN8, EAN13, ITF25, ITF14, UPCA and UPCE |
| | Minimum Resolution | 2D Codes | 0.278 mm (0.0109") |
| | | Barcodes | 0.070 mm (0.0027") |
| | Reading Distance | | 120 mm (4.7244") |
| | Reading Field of View | | 89 mm x 72 mm (3.5039" x 2.8346") (working distance at 120 mm (4.7244")) |
| | Maximum Reading Speed | | 30 codes/sec |
| I/O Specifications | Control Input | Number of Inputs | 2 |
| | | Input Type | Non-isolated Input |
| | Control Output | Number of Outputs | 2 |
| | | Output Type | Non-isolated Output |
| | Ethernet | Communication Standard | IEEE 802.3u Compliant, 100BASE-TX |
| | | Supported Protocol | SmartSDK, TCP Client, Serial, FTP, TCP Server and UDP |
| | Serial Communication | Communication Standard | RS-232C Compliant |
| | | Transmission Speed | 4800, 9600, 19200, 38400, 57600, 115200 bps |
| Environment Resistance | Enclosure Rating | | IP54 *2 |
| | Surrounding Temperature | | 0 to +45 °C (32 to 113 °F) |
| | Ambient Storage Temperature | | -30 to +70 °C (-22 to 158 °F) |

The product details are subject to change without further notice.

SPECIFICATION

| Type | | XS-90 |
|------------------------|---|--|
| Environment Resistance | Relative Humidity | 20% to 95% RH (No Condensation) |
| | Ambient Storage Humidity | 20% to 95% RH (No Condensation) |
| | Operating Environment | No Corrosive Chemical or Gas Present |
| Rating | Power Consumption | 2.4 W |
| | Power Supply Voltage | 24 VDC |
| | Current Consumption | 0.1 A |
| Weight | | Approx. 70 g (0.1543 lb.) |
| Dimension | | 45 mm (L) × 43 mm (W) × 25 mm (H) (1.7716" × 1.6929" × 0.9842") |
| VisionCodeX | Supported Operating System | Windows 7 Professional or later, 32 bit / 64 bit Windows 8 Professional or later, 32 bit / 64 bit (Except for Windows RT) Windows 10 Professional or later, 32 bit / 64 bit Windows 11 Professional or later, 32 bit / 64 bit |
| | Minimum Running Environment Requirement | Processor: 2.0 GHz and above (minimum 2 cores 32-bit or 64-bit) RAM: 8 GigaByte (GB) Storage: Required free space on hard disk 2 GB (for VisionCodeX Installation) Display: High definition (720p) display, 8 bits per colour channel |
| | Recommended Running Environment Requirement | Processor: 2.4 GHz and above (minimum 4 cores 32-bit or 64-bit) RAM: 16 GigaByte (GB) Storage: Required free space on hard disk 20 GB (for VisionCodeX Installation and data storage) Display: Full High definition (1080p) display, 8 bits per colour channel Graphics: Compatible with DirectX 12 or later with WDDM 2.0 Driver |

| Distance | | XS-90 (Standard Range) | | | | | | | |
|----------|---------|------------------------|---------|----------|---------|---------------|---------|----------|---------|
| | | MINIMUM RESOLUTION | | | | FIELD OF VIEW | | | |
| | | Barcode | | 2D Code | | Horizontal | | Vertical | |
| 120 mm | 4.7244" | 0.070 mm | 0.0028" | 0.278 mm | 0.0109" | 89.00 mm | 3.5039" | 72.00 mm | 2.8346" |

Note:

*1 LEDs are classified according to IEC 62471 (JIS C 7550).

- Exempt group: Objects that do not cause any photobiological damage.
- Risk group 1 (low risk): Objects that do not cause damage that make constraints on normal actions necessary.
- Risk group 2 (moderate risk): Objects that do not cause damage accompanied by unpleasant feelings and thermal discomfort.
- Risk group 3 (high risk): Objects that cause damage even due to temporary or short-term exposure.

*2 Water splashed against the enclosure from any direction will have no harmful effects. Device susceptible to damage if faced with jets of water, or temporary or continuous immersion in water.

The product details are subject to change without further notice.

DRAWING (Unit in mm, [inches])

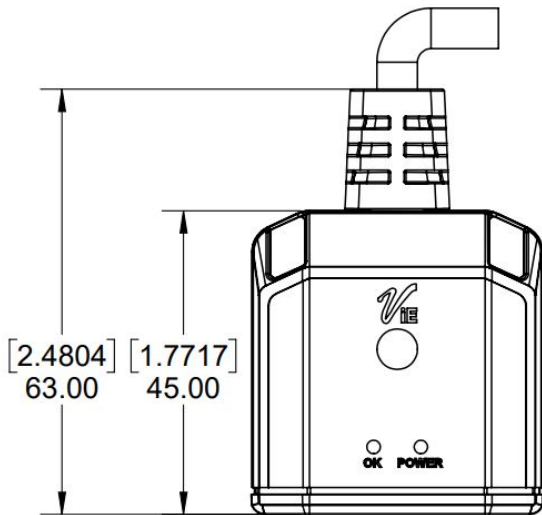

Top View

MOUNTING HOLES:
2 X M3 TAPPED HOLES
MAX DEPTH: 4 [0.1575]

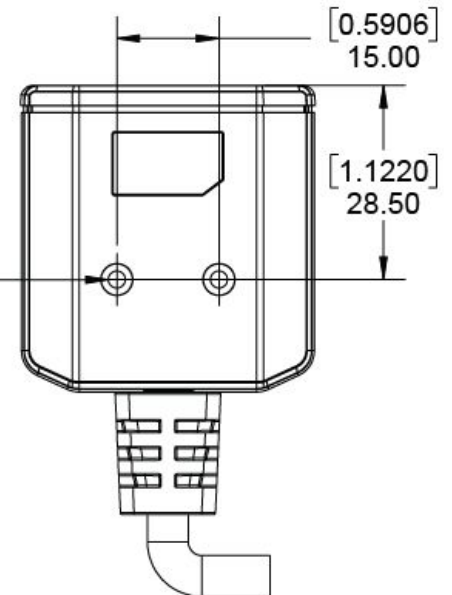

Bottom View

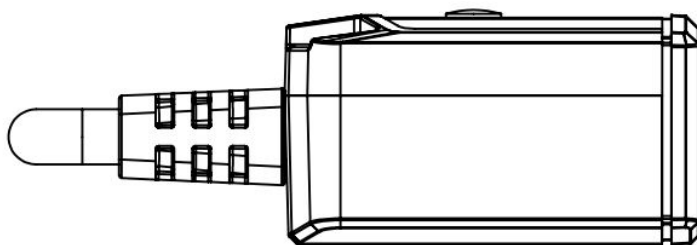

Left View

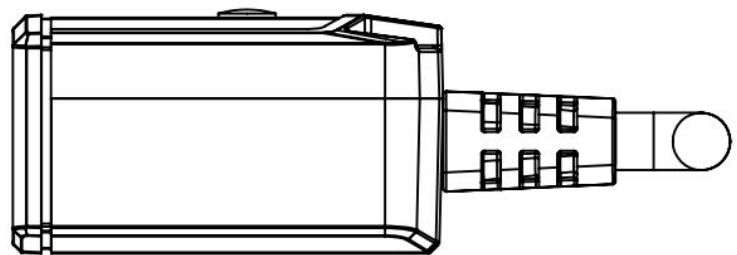

Right View

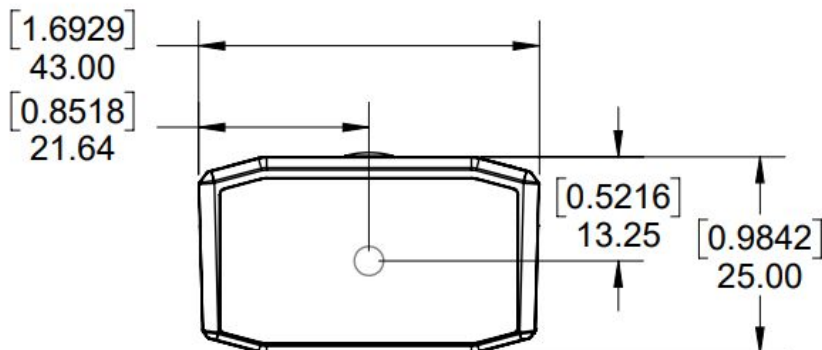

Front View

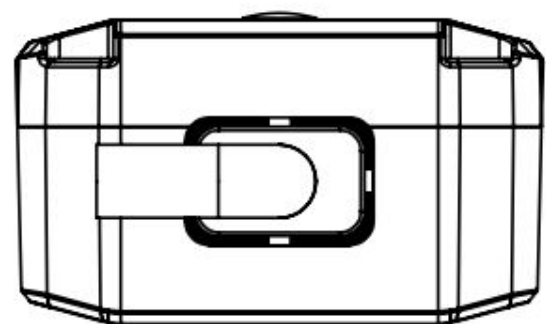

Back View

The product details are subject to change without further notice.